



ASPIRE

— TO MOVE —



Portland Place, Bath, BA1

Video & physical viewings available. Three bedroom, first floor flat, located at Portland Place. Suitable for students and sharers and available January 2025, offered unfurnished.

The flat is located on Portland Place, just 0.5 miles from central locations like Queens Square. Julian Rd convenience stores are just 0.1 miles away.

- Three bedroom flat
- Available from 18th JANUARY 2025
- Unfurnished
- Council tax band D - £2107.05
- Central location
- Suitable for three sharers/students
- Holding deposit £426.00

£1,850 PCM

Floor Plans

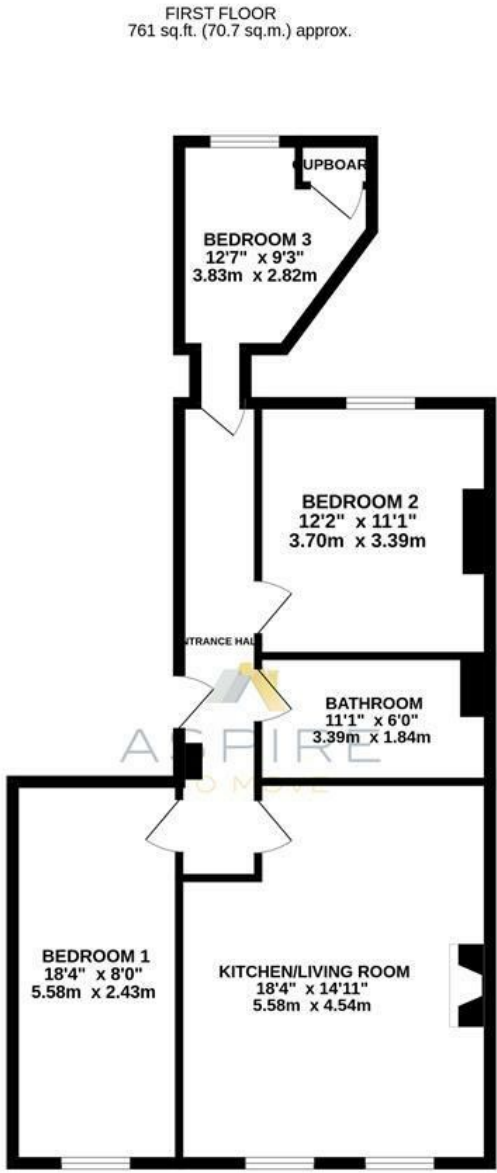

PORTLAND PLACE, BATH, BA1

TOTAL FLOOR AREA: 761 sq.ft. (70.7 sq.m.) approx.

Whilst every attempt has been made to ensure the accuracy of the floorplan contained here, measurements of doors, windows, rooms and any other items are approximate and no responsibility is taken for any error, omission or mis-statement. This plan is for illustrative purposes only and should be used as such by any prospective purchaser. The services, systems and appliances shown have not been tested and no guarantee as to their operability or efficiency can be given.

Made with Metropix ©2023

Energy Performance Graph

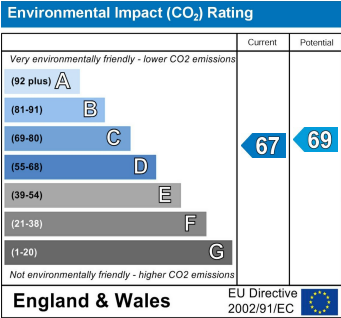
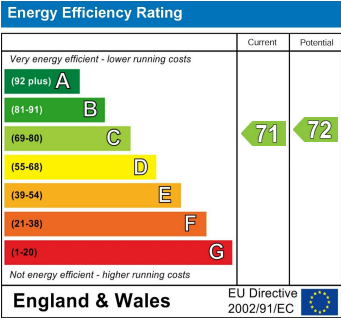

These particulars, whilst believed to be accurate are set out as a general outline only for guidance and do not constitute any part of an offer or contract. Intending purchasers should not rely on them as statements of representation of fact, but must satisfy themselves by inspection or otherwise as to their accuracy. No person in this firms employment has the authority to make or give any representation or warranty in respect of the property.